

Heart of Longmont Church Mission

Heart of Longmont's mission is "Putting more of God's love into the world". We have been serving those in need for over 150 years; doing what we can to alleviate suffering in the world. By partnering with The Inn Between of Longmont, the Wesley Homes will provide 12 permanently affordable apartments for low-income families. Our hope is to create long-term housing stability by offering safe, suitable housing for 50 kids and parents who can benefit from the on-site supportive services. We estimate completion of the project by late 2024.

Get In Touch

Contact Information



E-mail Address

office@heartoflongmont.org



Our Location

350 11th Avenue Longmont, CO 80501



Phone Number

(303) 776 - 3523



www.heartoflongmont.org/wesley-homes/#



Home is where the
Heart of Longmont
is! Introducing
"Wesley Homes"

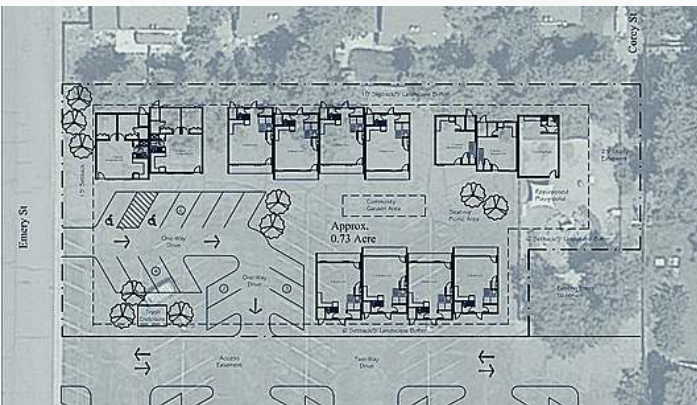

Introduction

What Inspired Wesley Homes

There is an urgent need for more affordable housing to serve those who are burdened by skyrocketing rental prices. Stable housing is a foundation for creating thriving communities, building strong families and reconciling inequities in wealth, health and education. Housing with supportive services helps children do better in school and adults develop new skills, re-enter the workforce, or pursue education. Crisis services are used less often which lowers public costs. Our entire community is strengthened for generations to come. To address this crisis, Heart of Longmont Church is donating a 3/4 acre parcel of land to The Inn Between to construct affordable homes for families.



The Name

Wesley Homes

John Wesley is the father of Methodism, noted for his work in assisting the poor in avoiding homelessness. He lived by his adage "Earn all you can, save all you can and give all you can". It is his words to "Do all the good you can, by all the means you can, at all the times you can, to all the people you can, as long as ever you can" which compelled The Heart of Longmont to enter into a partnership with The Inn Between to build homes for those in need, and to name the project "Wesley Homes". The Inn Between will own and manage Wesley Homes.

The Solution

Meet The Inn Between

The Inn Between of Longmont has been serving our community for 28 years and has become the largest local Affordable Supportive Housing agency. It was established in 1993 from the collective efforts of 23 community agencies seeking to address homelessness in the St. Vrain Valley. There was a need for an agency to provide affordable housing with supportive services to help people build stability. The Inn Between started with one 31 unit building and now owns six buildings with 88 units. Such housing capacity increases have helped our agency adapt to rising housing costs, offering the increasing number of families facing homelessness an affordable housing option that provides the time to build more economic strength.

